

## CARROLL COUNTY TECHNICAL TRANSPORTATION COMMITTEE

Hosted by The Area Plan Commission of Tippecanoe County

Members of the public may watch the livestream of the meeting at  
<https://www.facebook.com/TippecanoeCountyIndiana> and  
<https://www.youtube.com/c/TippecanoeCountyGovernment>

### I. Approval of Minutes from Previous Meeting(s)

### II. Traffic Counts

### III. Other Business

- a) Traffic Counter Purchases
- b) Merging Admin and Tech
- c) Roads Layer
- d) 18-Month Letting List

### IV. Citizen Comments

### V. Adjournment

Meeting Dates for 2024: November 21

Check the APC website at <https://www.tippecanoe.in.gov/378/Area-Plan-Commission-APC> for updates.

In accordance with the requirements of Title II of the Americans with Disabilities Act of 1990 ("ADA"), the Area Plan Commission of Tippecanoe County will not discriminate against qualified individuals with disabilities on the basis of disability in its services, programs, or activities. For more information visit [www.tippecanoe.in.gov/ada](http://www.tippecanoe.in.gov/ada).

**CARROLL COUNTY TECHNICAL TRANSPORTATION COMMITTEE  
MEETING MINUTES**

**May 16, 2024**

*Members of the public may watch the livestream of the meeting at  
<https://www.facebook.com/TippecanoeCountyIndiana> or <https://www.youtube.com/c/TippecanoeCountyGovernment>*

**MEMBERS PRESENT**

Nate LaMar	Delphi Police Department
Tony Liggett	Carroll County Sheriff
Aaron Lyons	City of Delphi
Donnie Shockley	Carroll County Highway Department
Mike Fincher	Carroll County Emergency Management

**MEMBERS ABSENT**

(vacant)	Area Plan Commission of Carroll County
Jerry Snavely, Jr.	Camden Street Commissioner
Jill Hammond	Camden Town Marshal
James Bishop	Flora Police Department
Kevin Shafer	Flora Street Commissioner
Debbie Lowe	Flora Airport
Matt Deitchley	INDOT Deputy Commissioner – LaPorte District

**ALSO PRESENT**

Tim Stroshine	Area Plan Commission of Tippecanoe County
Aria Staiger	Area Plan Commission of Tippecanoe County

Tim Stroshine called the meeting to order at 2:04 PM.

**I. APPROVAL OF MINUTES FROM FEBRUARY 15, 2024**

Mike Fincher moved to approve the minutes from the February 15, 2024 meeting. Donnie Shockley seconded, and the minutes were approved by unanimous voice vote.

**II. TRAFFIC COUNTS**

Aria Staiger reminded the attendees that sixty-five traffic counts are conducted each year, on a three-year cycle in the same locations. Armory Road has been a focus location for the past couple of years aside from the normal counts. About five weeks of counts have taken place so far this spring and another two weeks remain. More than the usual number of recounts will need to be done this year due to counters coming undone at various locations.

Tim Stroshine addressed the confusion of one of the count locations that was placed in an area that chip and seal work was being done. Donnie Shockley thought the counter should have been across the tracks on 900 North. He said the counter ended up in the town of Burrows on SR 25. Aria Staiger said the counter station will be relocated further away from town and counts will be taken again.

Tim Stroshine said other data can be collected with these counters including speed and vehicle classifications. If this type of data could be helpful for other work taking place in the county, he asked the attendees to reach out to him because this data is available from counts taken each year.

**III. OTHER BUSINESS**

**A. 18-Month Letting List**

Tim Stroshine referred to the eighteen-month letting list and noted the lack of projects occurring at this time. He said this is not uncommon because there are usually not many lettings throughout the summer. Two projects that were scheduled for September and October 2024 lettings have now been removed from the schedule, most likely due to financial concerns, and are showing revised project letting dates in 2029 and

2030. The small structure maintenance and repair project on SR 29, scheduled for an October 9, 2024, letting has been changed to December 11, 2024 letting. A full depth reclamation on SR 29 and a small structure maintenance and repair project on US 421 are both listed for a December 11, 2024 letting. Four new projects are shown on the letting list, one on US 421 and three on SR 75.

**IV. CITIZEN COMMENTS**

**V. ADJOURNMENT**

Meeting Dates for 2024: August 15, and November 21.

Mike Fincher moved to adjourn; Donnie Shockley seconded. The meeting was adjourned at 2:13 PM.

Respectfully submitted,  
Kristina Lamb  
Recording Secretary

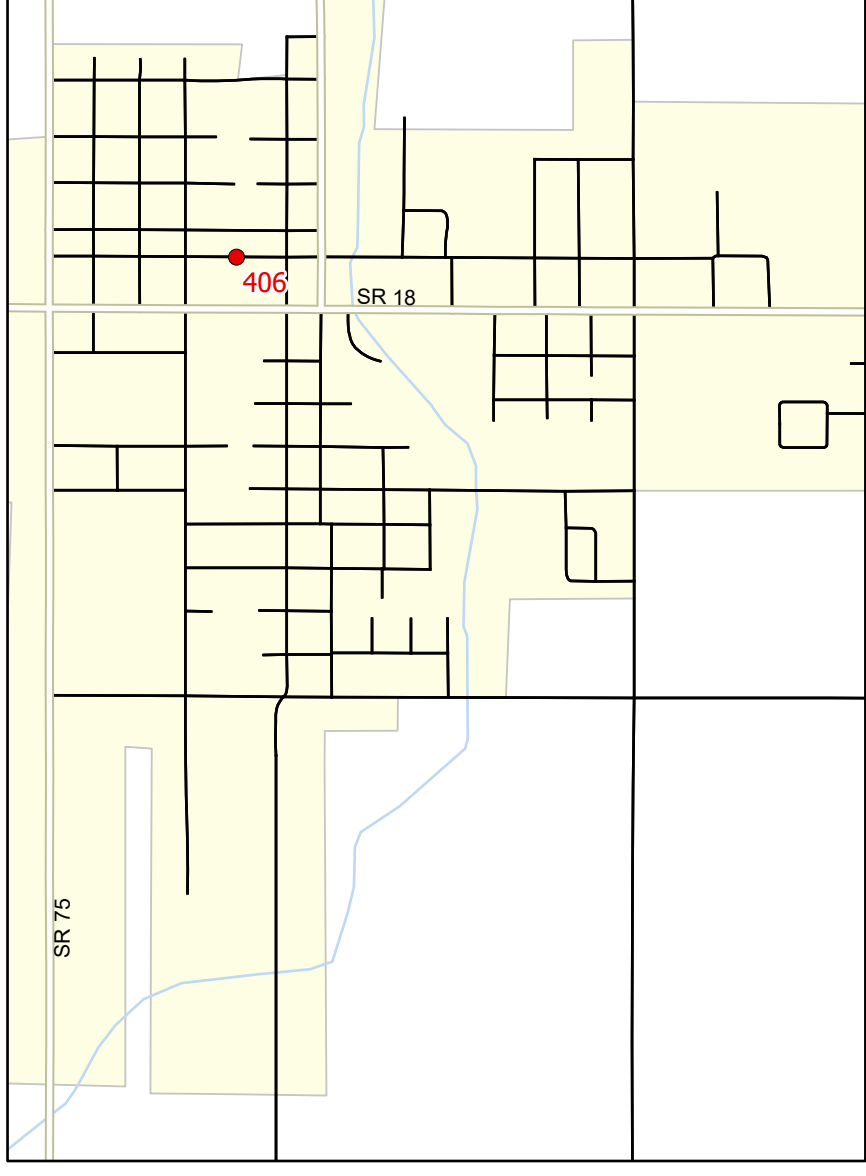
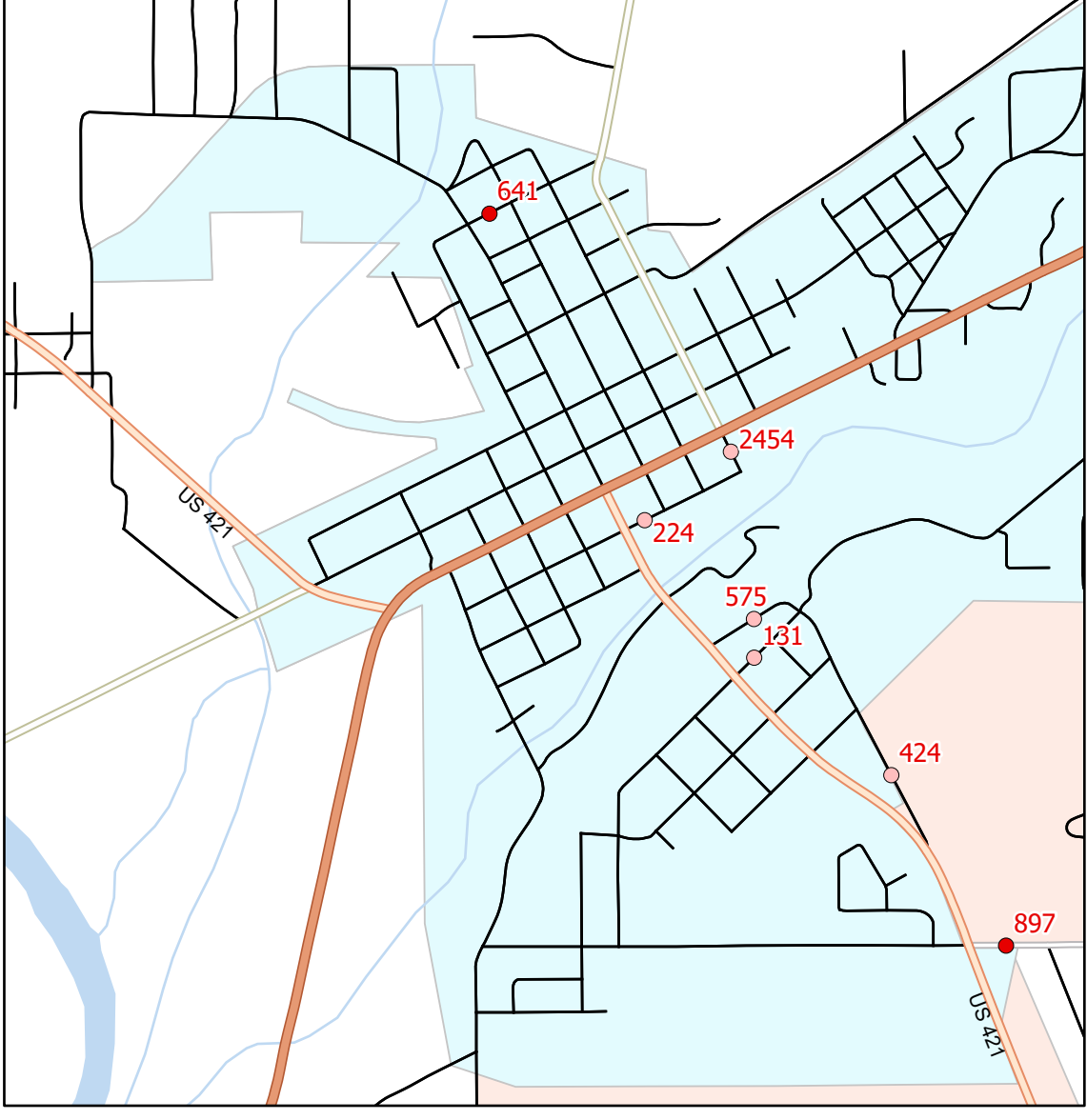
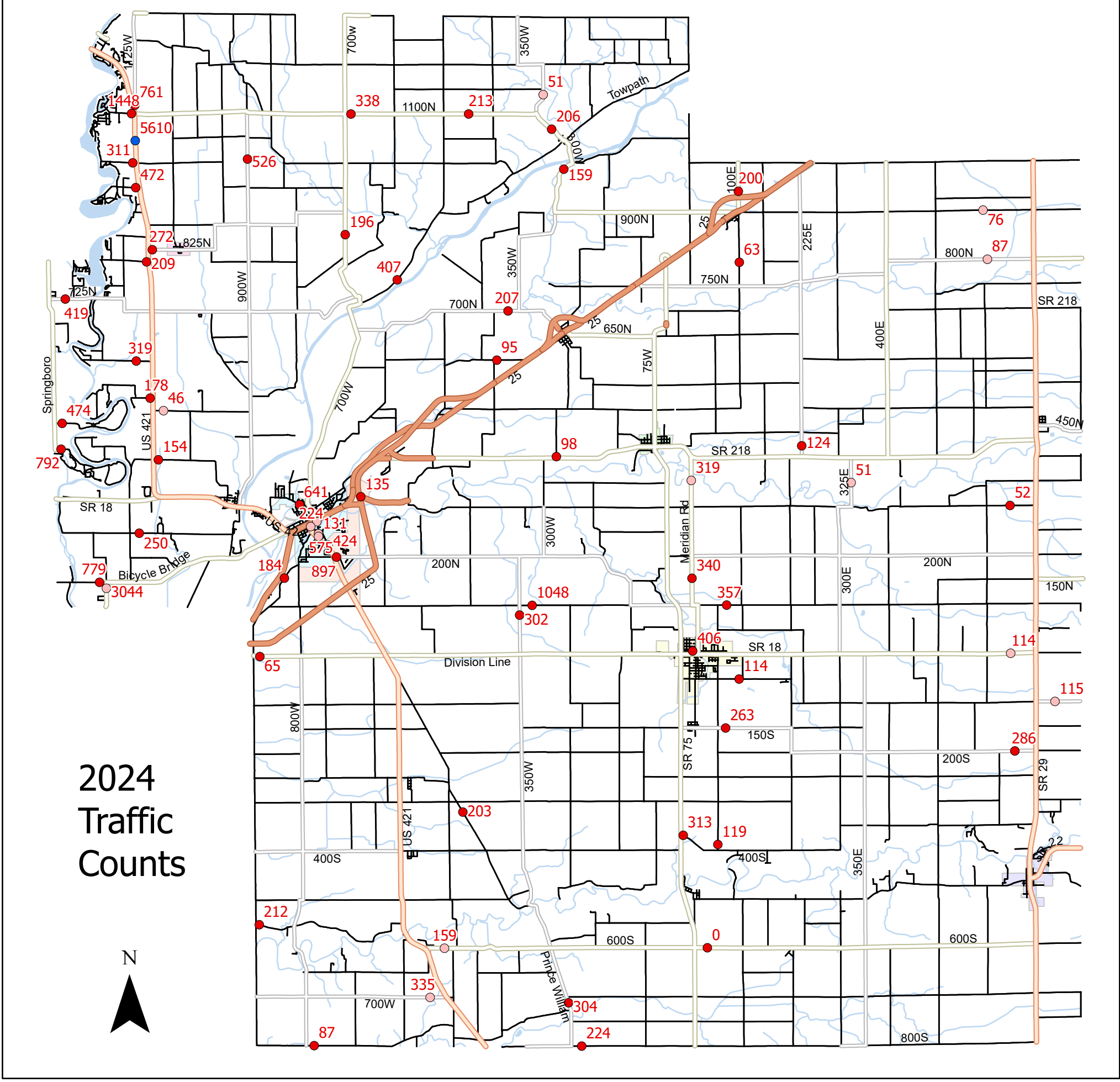

Street	Stn_Desc	AADT	Pssngr_Veh	Pssngr_Pct	TrucksAADT	Trucks_Pct	UnclasAADT	UnclassPct	Median_Spd	Speed_85th	Mean_Speed
W 600 S	Between 500 W and 550 W	159	116.7	0.7	41.5	0.3	0.5	0.0	46.0	56.0	46.4
E 800 N	Between 500 E and SR 29	87	55.3	0.6	30.5	0.3	1.4	0.0	44.0	56.0	45.8
W 800 N	Just W of US 421	209	138.2	0.7	64.8	0.3	5.7	0.0	61.0	88.0	57.7
E 300 N	Between 600 E and State Road 29	52	32.9	0.6	18.1	0.3	1.4	0.0	36.0	46.0	34.3
W 300 N	Just E of SR 25	135	110.5	0.8	24.5	0.2	0.0	0.0	31.0	37.0	31.3
W 1100 N	Just E of 700 W	338	225.4	0.7	111.5	0.3	1.0	0.0	44.7	53.9	45.1
W 1100 N	Between 400 W and 500 W	213	156.6	0.7	56.7	0.3	0.0	0.0	49.0	61.0	50.1
W 1100 N	Just W of US 421	1448	991.1	0.7	452.7	0.3	3.8	0.0	35.0	41.0	35.4
N 900 W	Between 950 N and 1050 N	526	406.5	0.8	118.2	0.2	1.0	0.0	56.7	76.5	60.5
N 1125 W	Between 1100 N and 1200 N	761	621.4	0.8	138.2	0.2	1.9	0.0	42.3	54.4	43.9
S 1200 W	S of Bicycle Bridge Rd	3044	1978.0	0.6	1054.0	0.3	12.4	0.0	42.6	65.6	48.7
N 300 W	Between 1040 N and 1100 N	206	92.7	0.4	113.4	0.6	0.0	0.0	53.1	62.7	52.9
N 350 W	Between Division Line Rd and 100 N	302	200.4	0.7	82.6	0.3	18.7	0.1	35.5	41.2	35.4
TOWPATH RD	Between 725 N and 875 N	407	326.7	0.8	79.3	0.2	0.5	0.0	51.8	60.2	51.1
MERIDIAN RD	Between State Road 218 and 300 N	319	228.7	0.7	88.9	0.3	1.0	0.0	51.8	59.2	50.6
MERIDIAN RD	Between 100 N and 200 N	340	255.9	0.8	75.3	0.2	9.1	0.0	32.5	40.3	32.4
MERIDIAN RD	Between 100 N and 200 N	150	128.8	0.9	18.3	0.1	2.9	0.0	33.2	40.7	33.1
N 700 W	Between 775 N and 900 N	196	169.1	0.9	26.9	0.1	0.0	0.0	54.9	63.7	55.1
W 950 N	Just W of US 421	472	370.2	0.8	101.5	0.2	0.0	0.0	36.1	43.1	36.3
N 275 W	Just W of 300 W	159	94.7	0.6	54.3	0.3	9.6	0.1	35.3	50.4	34.2
N 275 W	Just N of 400 N	98	67.2	0.7	22.9	0.2	8.1	0.1	24.4	34.1	25.3
W 825 N	Just E of US 421	272	226.3	0.8	42.4	0.2	3.3	0.0	35.3	44.1	36.5
N 100 E	Between 750 N and 900 N	63	37.5	0.6	25.5	0.4	0.0	0.0	49.1	68.1	51.0
N 100 E	S of E 1000 N	200	152.3	0.8	47.6	0.2	0.0	0.0	48.5	56.8	48.4
N 225 E	Between 400 N and 450 N	124	92.4	0.7	31.4	0.3	0.0	0.0	46.3	55.1	46.0
W 700 N	Between 350 W and 400 W	207	144.4	0.7	57.2	0.3	5.2	0.0	43.5	59.4	45.0
W 725 N	Between 1250 W and Springboro Rd	419	305.4	0.7	102.4	0.2	11.0	0.0	44.9	57.8	45.9
W 600 N	Just E of 400 W	95	74.0	0.8	20.7	0.2	0.0	0.0	41.1	49.4	41.1
W 600 N	Between US 421 and 1200 W	319	227.8	0.7	88.2	0.3	2.9	0.0	39.7	48.4	40.4
S 50 E	Just N of 400 S	119	88.2	0.7	29.5	0.2	1.4	0.0	30.9	39.9	32.4
MAIN ST	Between Center St and Willow St	406	388.9	1.0	16.2	0.0	0.5	0.0	24.5	29.6	24.2
E 150 S	Just E of 50 E	263	204.2	0.8	58.1	0.2	1.0	0.0	48.3	57.9	48.6
E 50 S	Between 50 E and 100 E	114	92.3	0.8	20.2	0.2	1.4	0.0	33.3	39.3	32.8
N 325 E	Between State Road 218 and 300 N	51	37.6	0.7	10.5	0.2	2.9	0.1	34.8	42.0	36.5
E 100 N	Between 50 E and 100 E	1005	698.5	0.7	296.4	0.3	10.0	0.0	59.0	77.9	60.8
E 100 N	Between 50 E and 100 E	357	272.9	0.8	75.4	0.2	8.6	0.0	57.7	67.0	58.7
W 100 N	Between 250 W and 350 W	1048	866.8	0.8	178.3	0.2	2.9	0.0	45.9	53.3	46.4
W 800 S	Just E of Prince William Rd	221	173.9	0.8	46.2	0.2	1.0	0.0	47.2	60.1	46.8
W 800 S	Just E of Prince William Rd	224	167.7	0.7	51.5	0.2	5.2	0.0	44.7	60.1	45.9
W 800 S	Just E of 800 W	87	61.5	0.7	24.8	0.3	0.5	0.0	36.3	52.4	39.9
W 800 S	Just E of 800 W	41	31.9	0.8	5.7	0.1	3.3	0.1	31.8	75.0	44.4
E 375 S	Just E of SR 75	313	210.6	0.7	98.2	0.3	4.3	0.0	35.8	43.1	36.0
PRINCE WILLIAM RD	Between 300 S and 400 S	203	162.0	0.8	41.5	0.2	0.0	0.0	50.8	60.5	50.9
PRINCE WILLIAM RD	Between 700 S and 725 S	304	226.3	0.7	74.8	0.2	3.3	0.0	46.9	64.7	49.0
BICYCLE BRIDGE RD	Just W of 1200 W	779	640.9	0.8	137.7	0.2	0.5	0.0	45.0	53.6	45.1
DEER MEADOWS RD	Between 800 W and 100 N	184	172.0	0.9	11.5	0.1	0.0	0.0	33.8	38.5	33.2
DIVISION LINE RD	Just E of 900 W	65	36.2	0.6	28.6	0.4	0.5	0.0	41.7	63.4	46.6
W 400 N	Just E of US 421	154	124.0	0.8	28.6	0.2	1.0	0.0	38.5	47.8	39.3
W 250 N	Between 1150 W and Troy Ave	250	147.2	0.6	102.9	0.4	0.0	0.0	41.9	51.4	42.4
W 475 N (HORSESHOE BEND RD)	Just E of Springboro Rd	474	403.6	0.9	70.5	0.1	0.0	0.0	40.3	49.4	41.1

Street	Stn_Desc	AADT	Pssngr_Veh	Pssngr_Pct	TrucksAADT	Trucks_Pct	UnclasAADT	UnclassPct	Median_Spd	Speed_85th	Mean_Speed
W 525 N	Just W of US 421	178	135.8	0.8	34.3	0.2	8.1	0.0	19.5	23.7	19.2
TECUMSEH BEND RD	Just E of Springboro Rd	792	633.3	0.8	133.9	0.2	24.8	0.0	25.7	29.9	25.3
W 1000 N	Between N 1175 W and US 421	311	254.5	0.8	55.8	0.2	1.0	0.0	42.1	52.3	43.1
E 200 S	Between SR 29 and 625 E	286	232.5	0.8	50.5	0.2	3.3	0.0	50.3	63.9	51.5
E 600 S	Between SR 75 and 100 E	701	578.8	0.8	119.4	0.2	2.4	0.0	57.5	66.8	58.0
E 600 S	Between SR 75 and 100 E	675	526.5	0.8	147.7	0.2	1.0	0.0	54.3	62.5	54.7
W 550 S	Just E of 900 W	212	151.5	0.7	53.4	0.3	7.1	0.0	43.1	50.9	43.4
E 900 N	Between N 500 E and State Rd 29	76	60.5	0.8	15.2	0.2	0.0	0.0	52.9	64.2	52.6
ADAMS ST	Between Union St and Washington St	641	496.8	0.8	123.0	0.2	20.7	0.0	20.8	27.1	21.5
Division Line Rd	Between N 600 E and SR 29	114	88.2	0.8	20.0	0.2	5.7	0.1	17.2	22.2	17.6
WILSON ST	Between Main St and Front St	2454	1414.1	0.6	986.9	0.4	53.3	0.0	53.0	79.3	60.1
E 100 S	Between SR 29 and county line	115	67.7	0.6	44.3	0.4	2.9	0.0	48.5	66.0	50.1
FRONT ST	Between Union St and Washington St	224	141.3	0.6	74.0	0.3	8.6	0.0	19.1	26.0	19.9
200 N	Between Washington St and Crestwood Dr	897	805.3	0.9	89.4	0.1	1.9	0.0	27.0	33.2	27.5
W 700 S	Between S 600 W and US 421	335	253.5	0.8	80.1	0.2	1.4	0.0	46.1	54.6	46.5
PRINCE WILLIAM RD	Between Vine St and Washington St	424	354.1	0.8	67.3	0.2	2.9	0.0	34.8	42.0	35.7
W 500 N	Between N 1025 W and US 421	46	29.1	0.6	16.7	0.4	0.5	0.0	32.8	41.4	31.8
NORTH ST	Between Washington St and Union St	131	113.9	0.9	13.5	0.1	3.8	0.0	20.7	27.5	20.7
N 300 W	Between 1050 N and 1100 N	51	45.6	0.9	5.3	0.1	0.5	0.0	34.2	39.5	34.0
PRINCE WILLIAM RD	Between Riley Rd and Washington St	575	478.6	0.8	60.5	0.1	35.6	0.1	20.8	23.9	20.8

		<b>TOTAL</b>	<b>32</b>	<b>24</b>	<b>23</b>	<b>22</b>	<b>13</b>	<b>7</b>	<b>5</b>	<b>4</b>	
		Delphi Mayor	Flora	Camden	INDOT	County Council	EDC	Delphi	County Commissioners	<b>TOTAL</b>	
2024	Q2	1	1							2	
2024	Q1	1	1		1					3	
2023	Q4	1				1				2	
2023	Q3	1				1				2	
2023	Q2	1	1		1	1	1			5	
2023	Q1	1	1			1	1			4	
2022	Q4	1	1				1			3	
2022	Q3	1	1			1	1			4	
2022	Q2	1	1				1			3	
2022	Q1	1	1	1			1			4	
2021	Q4	1		1	1		1	1		5	
2021	Q3	1	1	1	1			1		5	
2021	Q2	1			1					2	
2021	Q1	1		1	1					3	
2020	Q4	1		1	1			1		4	
2020	Q3	1		1	1					3	
2020	Q2	1		1	1					3	
2020	Q1	no meeting - COVID									
2019	Q4		1	1	1					3	
2019	Q3	1	1		1	1				4	
2019	Q2	1	1	1	1	1				5	
2019	Q1	1	1	1		1				4	
2018	Q4	1	1	1	1					4	
2018	Q3	1	1	1	1					4	
2018	Q2	1	1	1	1					4	
2018	Q1	1		1	1					3	
2017	Q4	1	1	1	1					4	
2017	Q3	1	1	1						3	
2017	Q2	1	1	1	1					4	
2017	Q1	1	1	1						3	
2016	Q4	1	1	1	1	1			1	6	
2016	Q3	1	1	1	1	1				5	
2016	Q2	1	1	1	1	1			1	6	
2016	Q1			1	1	1		1	1	5	
2015	Q4	1	1	1		1		1	1	6	

# 18 Month Letting List - August 6, 2024

(INDOT update: July 15, 2024)

	Letting Date	Road	Location	Type of Work	Des & Contract Number	Previous Letting Date
<b>S</b>	12/11/2024	SR 29	Over Price Plank Ditch, 0.92 miles north of JCT 218 W	Small Structure Maintenance and Repair	2200904 B-44725	
<b>S</b>	12/11/2024	SR 29	SR 29 from SR 218 (S JCT) to SR 218 (N JCT)	Full Depth Reclamation	1900180 R-42457	
<b>S</b>	12/11/2024	US 421	2.29 S JCT US 24/SR 39	Small Structure Maintenance and Repair	2100946 B-43840	
<b>S</b>	7/9/2025	US 421	From the North Junction of SR 18 to 1.50 Miles South of US 24 (Tippecanoe River)	HMA Overlay Minor Structural	2100228 B-43928	
<b>S</b>	9/10/2025	SR 75	At M Fork Wildcat Creek, 01.64 N SR 26	Bridge Rehabilitation Or Repair	1703010 R-41435	
<b>S</b>	9/10/2025	SR 75	At Bachelor Run, 01.17mi N of SR 18	Bridge Replacement	1703044 R-41435	
<b>S</b>	9/10/2025	SR 75	At M Fork Wildcat Creek, 01.64 N SR 26	New Bridge Construction	2101206 R-41435	
<b>N</b>	12/10/2025	SP 22	Old Sr 25@.-Deer Creek, 00.67mi S of US 421	Bridge Replacement	1800104 B-42436	
<b>NL</b>	10/9/2029	SR 29	Over Wildcat Creek, 0.48 miles north of SR 22	Bridge Deck Overlay	2002010 B-43347	10/9/2024
<b>NL</b>	9/11/2030	US 421	Over Deer Creek, 0.17 miles south of Old SR 25	Bridge Deck Overlay	2002086 B-45360	9/11/2024

Same, **New**, Change, **Not Listed**

## **Bid Letting Results**

None to Report